

Technical data

Time switch ASTROCLOCK-2

Technical data

Rated voltage As indicated in the device	230V~ /50-60Hz
Tolerance	± 10%
No. of output contacts	2
Rated current/switching voltage	2x 16A / 250 V~
Maximum recommended loads (N.A)	See Electrical scheme and parameters
Consumption	16 VA (1,3 W)
Display	back-lit liquid crystal display
Accuracy	± 1 s / day at 23 °C
Temperature effect on accuracy	± 0.15 s / °C / 24 h
Power reserve	4 years (without connection to mains), 48 h (without battery and without connection to mains)
Software class and structure	Class A
Memory spaces	40
Types of manoeuvres	SUNRISE, SUNSET, FIXED TIME: ON/OFF, REDUC.
Astronomical adjustment	Daily
Operating temperature	-10 °C ... +45 °C
Transport and storage temperature	-20 °C ... +60 °C
Pollution degree	2
Protection level	IP 20 (EN60529)
Overvoltage category	Class II under correct mounting conditions
Transient impulse voltage	2.5 kV
Keyboard access cover	Sealable
Connection	With screw terminal for section conductors of 4mm ² maximum section
Battery	CR2032 - 3 V - 220 mAh
Size	2 DIN modules (35 mm)

Electrical scheme and parameters

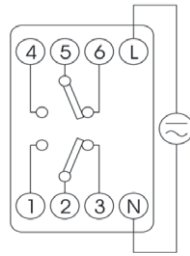

Incandescent 3000 W	Fluorescent 1200 VA	Low voltage halogen (12 V AC) 2000 VA	Halogen (230 V AC) 3000 W
Low consumption lamps 600 VA	Downlights 400 VA	LED 90 VA	

Dimensions

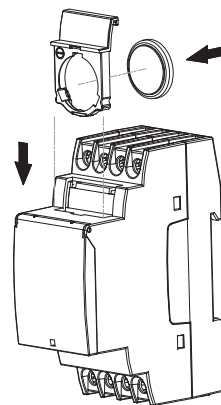
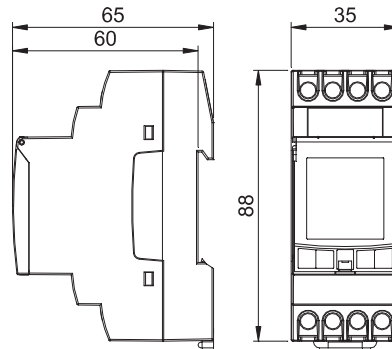

Digital time switch ETICLOCK-R1

EVE - ETIREL

Technical data	
	ETICLOCK-R1
Rated voltage and frequency As indicated on the device	(230 V ~ 50-60Hz)
Breaking capacity	μ 1x16 (10) A / 250 V AC
Own consumption	16 VA (1.3 W) max
Contact	AgSnO2 switched
Display screen	LCD
Running accuracy	\pm 1 s / day at 23 °C
Accuracy variation with temperature	\pm 0.15 s / °C / 24 h
Power reserve	4 years (with battery and no network connection)
	48 h (no battery and no network connection)
Memory spaces	40
No. of channels	1
Types of operations	ON/OFF, PULSE (1 ... 59 sec.) & CYCLES (1 ... 59 sec. / 1 min ... 23h, 59 min)
Operating temperature	-10 °C ... +45 °C
Transport and storage temperature	-20 °C ... +60 °C
Pollution degree	2
Protection level	IP 20 (EN60529)
Protection class	II under correct mounting conditions
Transient impulse voltage	2.5 kV
Temperature for the ball test	+ 80 °C (21.2.5)
Keyboard access cover	Sealable
Connection	With screw terminal for wire cross section of up to 4mm ²
Battery	CR2032 - 3 V - 220 mAh
Size	2x DIN mod. (35 mm)

Connection

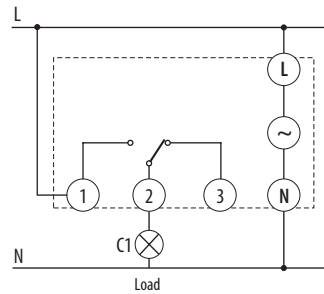

Controlling elements

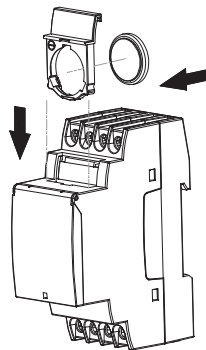
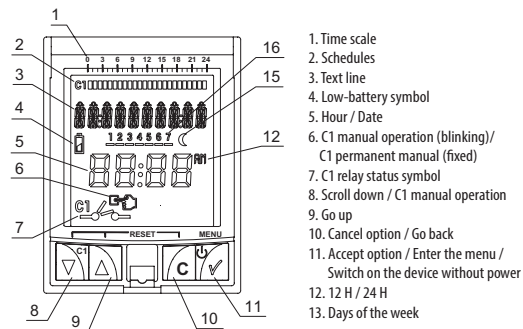

Dimensions

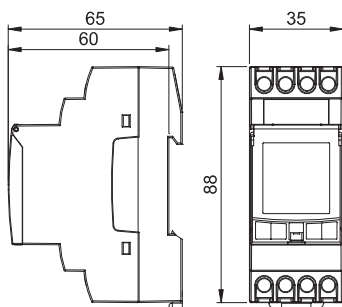

Maximum recommended loads

Load	Designation	Max. load
Incandescent		3000 W
Fluorescent		1200 VA
Low voltage halogen (12 V)		2000 VA
Halogen (230 V)		3000 W
Low consumption lamps		600 VA
Downlights		400 VA
LED	LED	90 VA